

Owner HORVATH, ANN
Address 2919 TAMPA AVE
 CLEVELAND, OH. 44109
Land Use (5100) R - 1-FAMILY PLATTED LOT
Description 62 MEADE 0090 ALL
Neighborhood Code 02153

SKETCH

MAP VIEW

Map Image

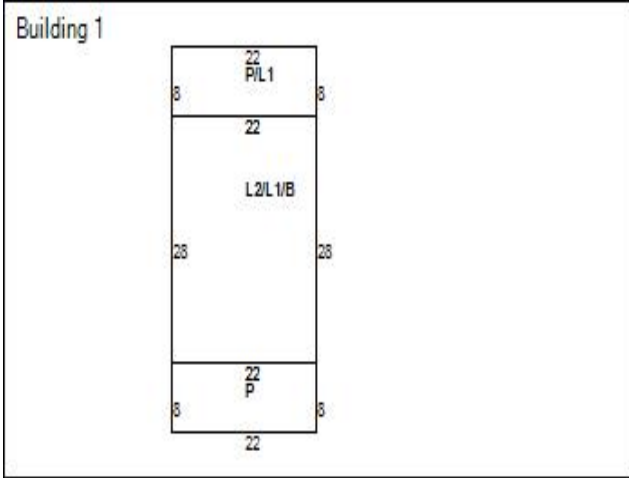

BUILDING INFORMATION

Building Record Number	1	Occupancy	1-FAMILY	Story Height	2
Style	COLONIAL	Year Built	1893	Exterior Walls	ALUM/VINYL
Condition	AVERAGE	Construction Quality	C+ / AVERAGE+	Roof Type	GABLE
Roof Material	ASPH-SHINGLE	Heat Type	FORCED-AIR	Air Conditioning	NONE
Attic Type	NONE	Basement Type	BASEMENT	Basement Square Feet	616
Basement Finished	No	Rooms	7	Bedrooms	3
Bathrooms (Full/Half)	1/0	Garage Type	NONE	Garage Capacity	
Year Garage Built		Garage Size		Living Area Basement	
Living Area 1	792	Living Area 2	616	Living Area Upper	
Living Area Total	1,408	Floor Location		Party Wall	

LAND

VALUATION

Code	Frontage	Depth	Acreage	Sq Ft
PRM	41	116	0.11	4,756

2022 Values	Taxable Market Value	Exempt Market Value	Abated Market Value	Assessed Taxable Value
Land Value	\$16,500	\$0	\$0	\$5,780
Building Value	\$44,400	\$0	\$0	\$15,540
Total Value	\$60,900	\$0	\$0	\$21,320
Land Use	5100			SINGLE FAMILY DWELLING

PERMITS

IMPROVEMENTS

Tax Year	Reason	Tax Change	Exempt Change	Percent Complete	Reinspect	Notes
2009	30 - New Construction	\$	\$	100%	No	EXTERIOR ALTERATION - FRONT PORCH 100% COMPLETE NO VALUE CHANGE 1-1- 2009
2005	30 - New Construction	\$	\$	100%	No	INT-EXT ALTS100% CMPNV 1-1- 2005

Type	Description	Size	Height Depth
------	-------------	------	--------------

SALES

Date	Buyer	Seller	Price
12/6/1989	Horvath, Ann	Hovath Ann,	\$0
12/6/1989	Hovath Ann,	Horvath, Ann.	\$0
12/6/1989	Horvath, Ann.	Horvath Ann (Life Est)	\$38,000
5/11/1989	Horvath Ann (Life Est)	Brown Melvin G	\$0
1/1/1975	Brown Melvin G		\$0

Taxes

2022 Taxes	Charges	Payments	Balance Due
Tax Balance Summary	\$1,793.67	\$1,319.70	\$473.97