

Owner TIMBS, MARY E
Address 475 MEADOWLANE RD
 SEVEN HILLS, OH. 44131
Land Use (5100) R - 1-FAMILY PLATTED LOT
Legal Description 31 3-37 CITYA 0008 SEC
Neighborhood Code 08111

SKETCH

MAP VIEW

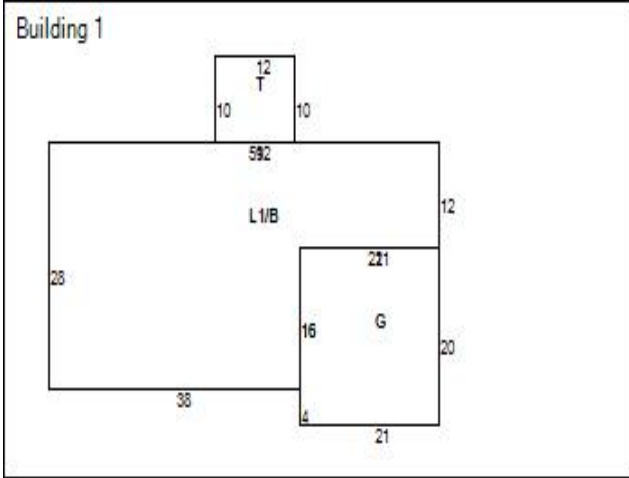

BUILDING INFORMATION

Building Record Number	1	Occupancy	1-FAMILY	Story Height	1
Style	RANCH	Year Built	1957	Exterior Walls	FRAME
Condition	GOOD	Construction Quality	B / GOOD	Roof Type	GABLE
Roof Material	ASPH-SHINGLE	Heat Type	FORCED-AIR	Air Conditioning	CENTRAL
Attic Type	NONE	Basement Type	BASEMENT	Basement Square Feet	1,316
Basement Finished	No	Rooms	6	Bedrooms	3
Bathrooms (Full/Half)	1/1	Garage Type	ATTACHED	Garage Capacity	2
Year Garage Built	1957	Garage Size	420	Living Area Basement	
Living Area 1	1,316	Living Area 2		Living Area Upper	
Living Area Total	1,316	Floor Location		Party Wall	

LAND

VALUATION

Code	Frontage	Depth	Acreage	Sq Ft
PRM	100	306	0.68	29,682

2022 Values	Taxable Market Value	Exempt Market Value	Abated Market Value	Assessed Taxable Value
Land Value	\$46,100	\$0	\$0	\$16,140
Building Value	\$129,400	\$0	\$0	\$45,290
Total Value	\$175,500	\$0	\$0	\$61,430
Land Use	5100			SINGLE FAMILY DWELLING

PERMITS

IMPROVEMENTS

Tax Year	Reason	Tax Change	Exempt Change	Percent Complete	Reinspect	Notes
----------	--------	------------	---------------	------------------	-----------	-------

Type	Description	Size	Height Depth
------	-------------	------	--------------

SALES

Date	Buyer	Seller	Price
11/11/2020	TIMBS, MARY E	TIMBS, MARY E. & TIMBS, II, ERNEST PAUL	\$0
5/1/2019	TIMBS, MARY E. & TIMBS, II, ERNEST PAUL	TIMBS, MARY E.	\$0
5/1/2019	TIMBS, MARY E.	TIMBS, ERNEST P. & MARY E.	\$0
8/19/2013	TIMBS, ERNEST P. & MARY E.	TIMBS, ERNEST P. & MARY E. & ERNEST P. II	\$0
4/12/2012	TIMBS, ERNEST P. & MARY E. & ERNEST P. II	Timbs Ernie P	\$0
4/1/1980	Timbs Ernie P	Timbs Ernie P & Mary E	\$0
1/1/1975	Timbs Ernie P & Mary E		\$0

Taxes

2022 Taxes	Charges	Payments	Balance Due
Tax Balance Summary	\$10,098.95	\$0.00	\$10,098.95