

Portage County, Ohio - Property Record Card
 Parcel 31-361-24-00-059-000
 Card 1

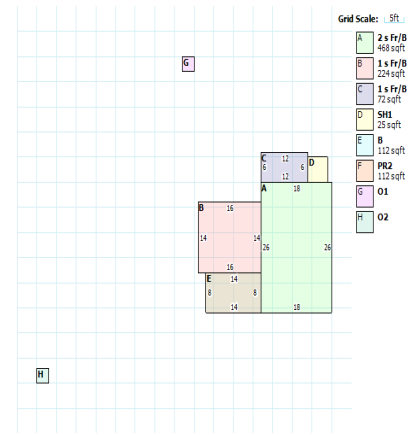

GENERAL PARCEL INFORMATION

Owner HESTER TORINO F SR
 Property Address 471 KING
 Mailing Address
 Land Use 510 - Single family Dwlg
 Deed CURRENT DEED VOLUME/PAGE: /
 Legal Description L W H DIV 3 LOT 17
 F 66.00

VALUATION

	Appraised	Assessed
Land Value	\$20,200.00	\$7,070.00
Improvements Value	\$70,000.00	\$24,500.00
CAUV Value	\$0.00	\$0.00
Taxable Value	\$31,570.00	
Net Annual Tax	\$2,036.27	

RESIDENTIAL

Building Style	Conventional	Full Baths	1
Year Built	1930	Half Baths	0
Stories	2	Basement	Full Basement
Finished Area	1232	Finished Basement Area	0
First Floor Area	764	Heating	Base
Half Floor Area	0	Cooling	None
Upper Floor Area	468	Exterior Wall	Frame/Siding
Rooms	6	Attic	None
Bedrooms	3	Number of Fireplace Openings	0
Family Rooms	0	Number of Fireplace Stacks	0

LAND

Land Type	Acreage	Depth	Frontage	Depth	Value
L1 - Regular Lot	0.2273	150	66	111%	20150

ADDITIONS

Description	Area	Year Built	Value
SH1 - Shed Frame or Equal	25	0	420
PR2 - Porch Frame -	112	0	6150

IMPROVEMENTS

Description	Year Built	Dimension	Area	Value
Garage Frame - 1	1930	22x16	352	\$1,000.00
Shed Utility - 60	1930	12x10	120	\$400.00

AGRICULTURAL

SALES

Date	Buyer	Seller	Price
6/12/2007	HESTER TORINO F SR	WELLS FARGO BANK NA	\$79,000.00
2/22/2007	WELLS FARGO BANK NA	TIMBERMAN JAMES E	\$73,800.00
7/26/2005	TIMBERMAN JAMES E	BENSON SUSAN L	\$110,650.00
6/22/2005	BENSON SUSAN L	BENSON MATTHEW I &	\$0.00
9/22/1994	BENSON MATTHEW I &	Unknown	\$38,700.00

COMMERCIAL

Grid Scale: 5ft

- A** 2 s Fr/B
468 sqft
- B** 1 s Fr/B
224 sqft
- C** 1 s Fr/B
72 sqft
- D** SH1
25 sqft
- E** B
112 sqft
- F** PR2
112 sqft
- G** O1
- H** O2

G

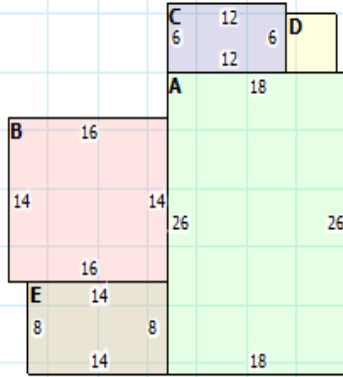

H